

**onza**  
 WHEN IT'S TIME TO WIN  
A HISTORY OF RACE INNOVATION

1666 NINTH STREET  
 SANTA MONICA, CA 90404-3704  
 (310) 392-2004

PART #: BPD-1401---STAINLESS STEEL SPINDLE  
 BPD-1402---TITANIUM SPINDLE  
 BPD-1403---CROMO SPINDLE

ONZA H.O. HIGH OUTPUT PEDAL

**IMPORTANT! READ BEFORE USE:**

- Before riding practice engaging and disengaging motions several times with one foot firmly on the ground.
- Adjust retention force to a level that suits your skill level and personal preference. See Adjusting Retention Force.
- Ride only on level ground until you are thoroughly familiar with engaging and disengaging from the pedal.
- To ensure proper engagement and disengagement, keep cleat and pedal binding free of all foreign substances.

**Warranty is invalid unless this product is installed by a professional bicycle shop.**

**INSTALLATION:**

- 1) Lightly apply grease to pedal spindle threads. (Or anti-seize compound on titanium models.)



- 2) When mounting pedals on crank, remember, right pedal is right-hand threaded and left pedal is left-hand threaded. Using a 15mm wrench, torque to at least 350kgfcm (25.6 ft. lbs.) Pedal torque should be checked periodically.

**ADJUSTING RETENTION FORCE:**

Change colored elastomer pads to adjust retention force. Pedals are assembled with lightest elastomer. It is recommended that you start with the clear elastomer to become familiar with the pedal. Then change elastomers to suit your riding style using the following guideline:

Color	Release Tension
Clear	Extra-Light
Gray	Light
Blue	Medium
Black	Heavy



**CAUTION:**

Do not mix different color elastomers, inconsistent release will result.

**ATTACHING CLEAT:**

**IMPORTANT:**

Use proper length cleat mounting bolts. Two lengths are included.

If shoe does not have built-in cleat nut, complete following steps before proceeding to Step 1:

- Remove sock liner of shoe and place supplied cleat nut over slots inside shoe.
- Holding cleat nut in position, turn shoe over.



Each cleat offers six degrees or ten degrees of float. For six degrees of float install cleat with six toward toe of shoe; for ten degrees of float install cleat with ten toward toe of shoe.

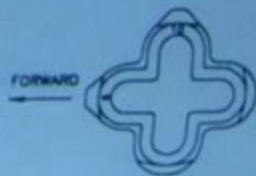

- 1) Set cleat, plug and cleat plate on bottom of shoe over cleat nut.

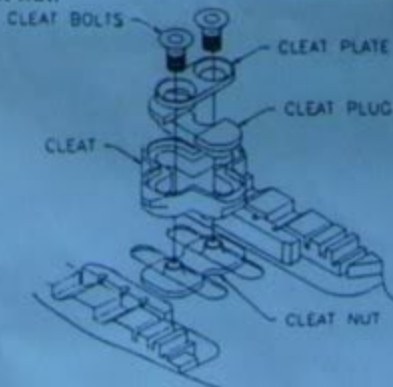

2) **Temporarily** tighten cleat mounting bolts.  
Temporary torque: 25kgfcm (1.9 ft. lbs.)

3) Engage and disengage each shoe, adjusting cleat a number of times to determine the best cleat position.

Cleat has 5mm of side to side adjustment. Front to back adjustment is determined by length of slots in shoe.

4) After determining cleat position, tighten mounting bolts to 50kgfcm (3.7 ft. lbs.) Do not over-tighten.

**USE:**

Engaging: Press cleat into pedal.

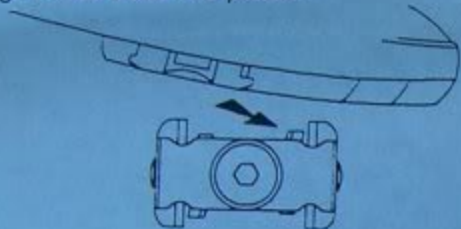

Disengaging: Twist heel to release.

Practice engaging and disengaging with one foot on the ground until you become familiar with the retention system.

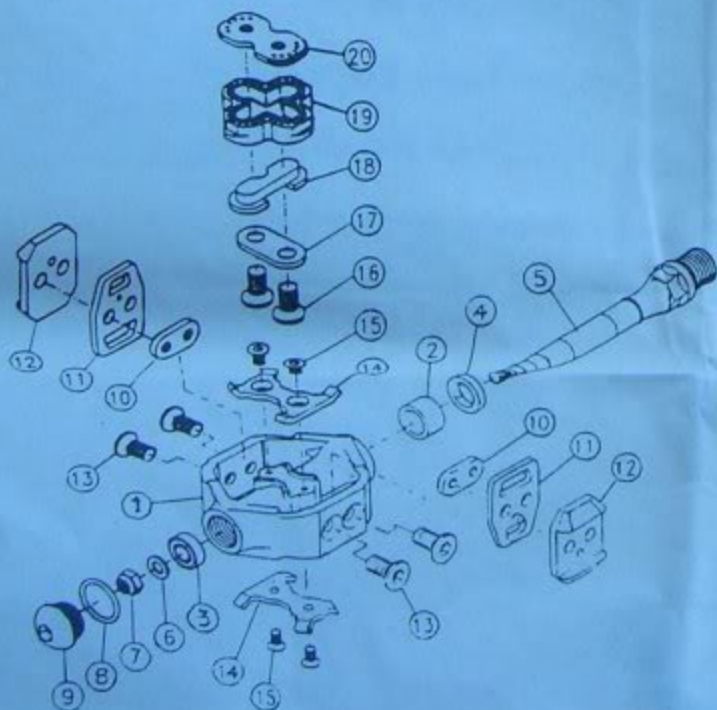

**LIMITED WARRANTY**

ONZA WARRANTS THIS PRODUCT TO BE FREE FROM DEFECTS IN MATERIAL AND WORKMANSHIP FOR A PERIOD OF ONE YEAR. ONZA WILL, AT ITS SOLE DETERMINATION, REPAIR, OR REPLACE THIS PRODUCT FOUND TO BE DEFECTIVE. NORMAL WEAR AND TEAR EXCLUDED. SHIPPING AND / OR DEALER LABOR CHARGES ARE NOT COVERED BY THIS WARRANTY. THIS LIMITED WARRANTY DISCLAIMS ALL IMPLIED WARRANTIES AFTER EXPIRATION OF THIS EXPRESS LIMITED WARRANTY. INCIDENTAL OR CONSEQUENTIAL DAMAGES THAT MAY RESULT FROM THE FAILURE OR MALFUNCTION OF THIS PRODUCT ARE NOT COVERED BY THIS WARRANTY.

**Replacement Part Kits**

Description	Part No.
Stainless Steel Spindle / Bearings (2-9)	PDA-1404
Titanium Spindle / Bearings (2-9)	PDA-1405
Retention Plates / Bolts (10,11 & 13)	PDA-1406
Elastomer Sets-4 Densities (12)	PDA-1407
Guide Plates / Screws (14 & 15)	PDA-1408
6°-10° Cleat / Bolts (16-20)	PDA-1409